

REV.	DESCRIPTION	ECN NO.	NAME	DATE
0	FIRST EDITION	N/A	SYH	2022-05-27

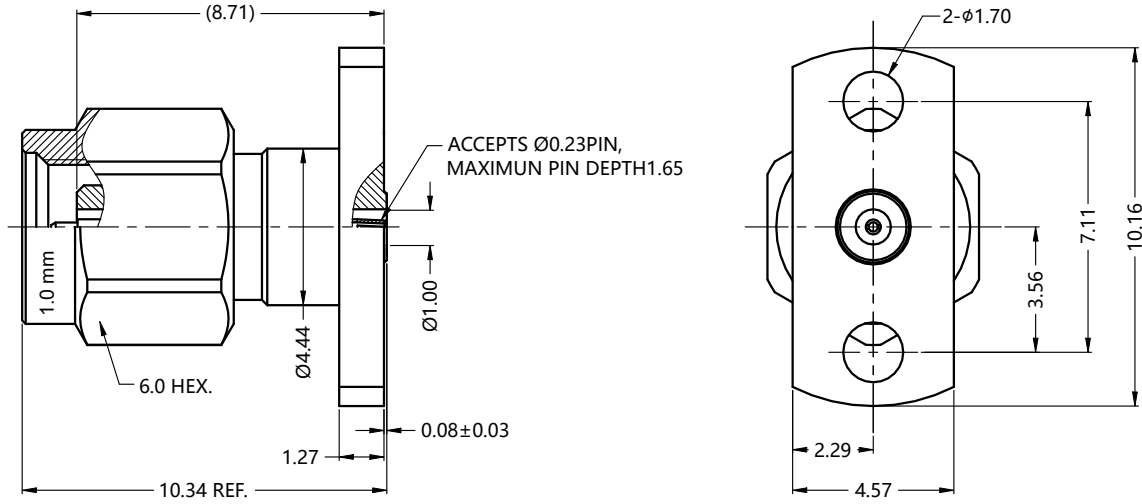

ALL PARTS MUST MEET TO RoHS REQUIREMENTS



MATERIALS AND PLATING)UNIT: MICRO-INCHES		
PART NAME	MATERIALS	PLATING
BODY/SHELL	STAINLESS STEEL	PASSIVATION
INSULATOR	PEI	N/A
CONTACT PIN	Be-Cu C17300	GOLD 50 u"/CHEMICAL NICKEL

ELECTRICAL CHARACTERISTICS		
Impedance	50 Ω	
Voltage rating	170 V(rms)	
Frequency range	DC ~ 110 GHz	
Dielectric withstanding voltage	>500 V	
Contact resistance	Center contact	<4.0 mΩ
	Outer contact	<1.0 mΩ
Insulation resistance	>1000 MΩ	
Insertion loss	<0.60 dB (After bisected)	
VSWR	DC ~ 67 GHz	<1.25(Take the square root of two pcs)
	67 ~ 110 GHz	<1.35(Take the square root of two pcs)
3rd Intermodulation	N/A	

MECHANICAL CHARACTERISTICS	
Force to engage and disengage	N/A
Center contact retention force	>3 lbs
Recommended coupling torque	3.5 ~ 4.4 in-lbs
Coupling nut retention force	>50 lbs
Durability	>500 cycles

ENVIRONMENTAL PARAMETER	
Temperature range	-40 °C ~ +125 °C

CUSTOMER OUTLINE DRAWING

*** CUSTOMER OUTLINE DRAWING**

UNLESS OTHERWISE SPECIFIED:
 1) EDGES: C0.15 MAX ;
 2) REMOVE ALL BURRS;
 3) SURFACE ROUGHNESS: Ra0.8 ;
 4) UNITS:mm;
 5) DIMENSIONS TOLERANCES
 DECIMALS .x ±0.5, .xx ±0.3, .xxx±0.2;
 ANGLES ±8°.

THIRD ANGLE PROJECTION	
APPROVED:	CUSTOMER P/N:
CHECKED:	SCALE: 5 : 1
DRAWING:	DATE: 2022-05-27 PAGE : 1/1

TITLE: 1.0mm MALE FOR
2-HOLES FLANGE,50Ω
DRAWING NO.: T-5T1M84S-H21
COMPANY WEBSITE : www.slkcorp.com